

NFTA also plans to improve additional segments between the BRT stations, as funds allow. Current estimates suggest the project will include 2.5 miles of sidewalk (on both sides of the street). The map to the right shows areas where we are currently planning to replace sidewalks. This will make it safer, more comfortable to walk, and improve the overall look and feel of the corridor.



SIDEWALK

Improvements to sidewalks and curbs will be made at the intersections around the BRT stations. Additional upgrades to select segments between BRT stations may be included. The exact treatments will be determined during design based on the land use typologies and in coordination with the City of Buffalo, who are overseeing a multi-phase streetscape and roadway redesign called, Build Back Bailey.

STREETSCAPING

Street trees provide shade, help cool the corridor, manage stormwater, and clean the air. The exact locations and types of street trees to be planted will be determined in coordination with the City of Buffalo.

SIDEWALK & STREETSCAPE

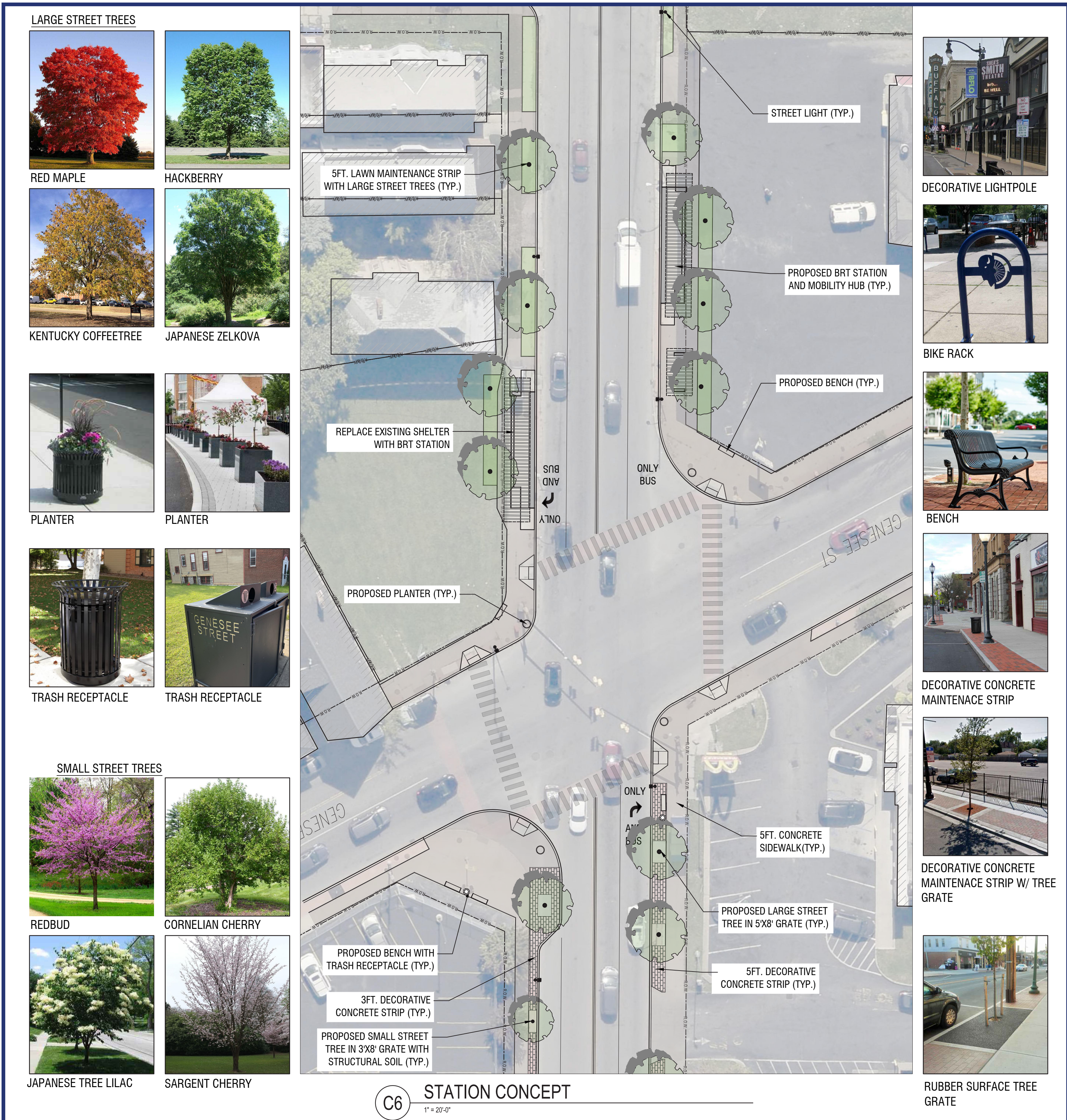
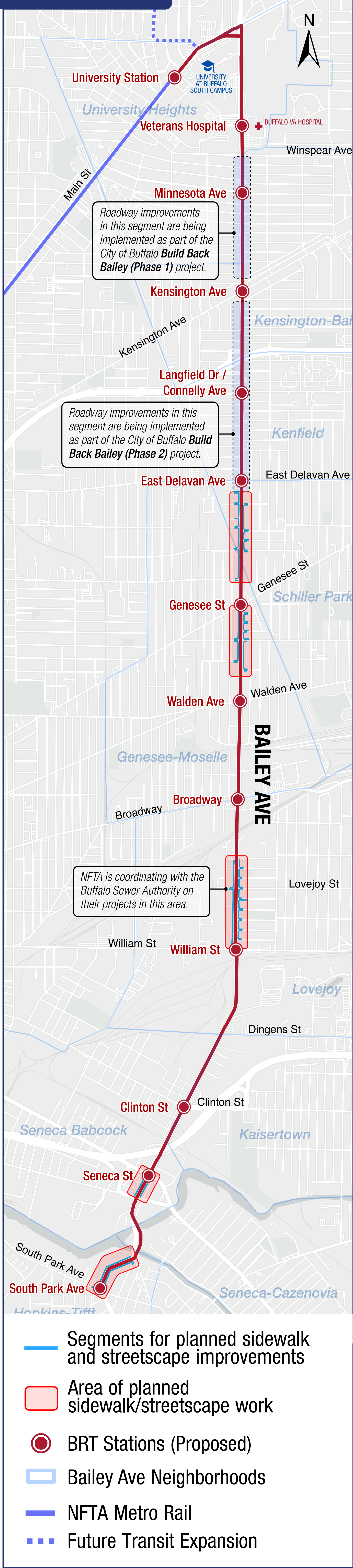

A landscape architecture plan is critical to establishing a consistent, efficient, safe, and aesthetically pleasing streetscape across the entire corridor. This plan example outlines current recommendations for the Genesee St BRT station and mobility hub that are based off of the Buffalo Green Code.