

FACADE



FACADE-11



FACADE-6

Facade luminaires are a specialized type of wall-mounted street lighting designed to illuminate buildings. Their design ensures the formation of a primary light beam parallel to the wall, enabling effective decorative illumination of building facades and structures. These luminaires seamlessly integrate into modern interiors and exteriors.

A modern luminaire designed for lighting:

- Building facades
- Recreation areas
- Leisure zones
- Entrances
- Entrance areas
- Patios
- Balconies
- Verandas
- Cottages
- Country houses
- Access roads

Housing: Aluminum.

Light Source: Samsung LEDs (South Korea).

Power Supply: HELVAR (Finland).

Package Contents: Luminaire with integrated LED light source and installation kit.

Model	FACADE-6	FACADE-11
Operating Voltage (V)	220	
Operating Temperature (°C)	from - 30 to + 50	
Correlated Color Temperature (CCT, K)	4000 (on request 3000, 5000, 6000)	
Ingress Protection (IP)	IP44	
Impact Resistance (IK)	IK03/0.35 J	
Rated Power (W)	6	11
Luminous Flux (lm)	780	1430
Luminous Efficacy (lm/W)	130	
Light Source	Samsung LEDs (South Korea)	
Power Supply	HELVAR (Finland)	
Direction Of Light	one side	two sides
Installation	Wall mounted	
Dimensions (LxWxH, mm)	120x90x75	180x105x75

Lamp Sketch

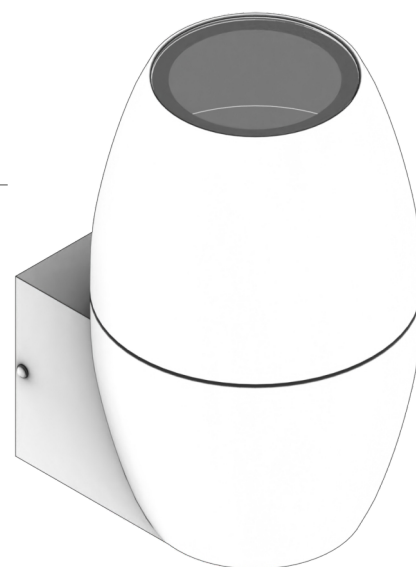
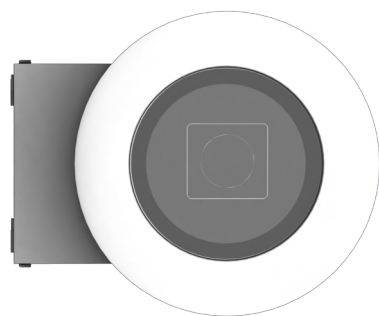
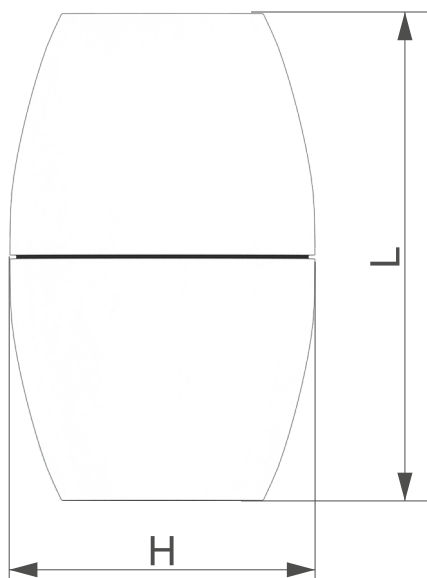
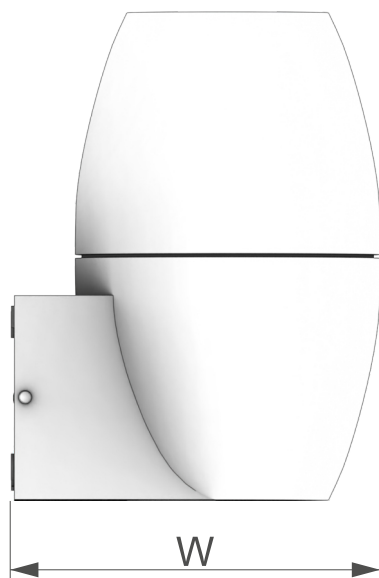

FACADE-6

Lamp Sketch

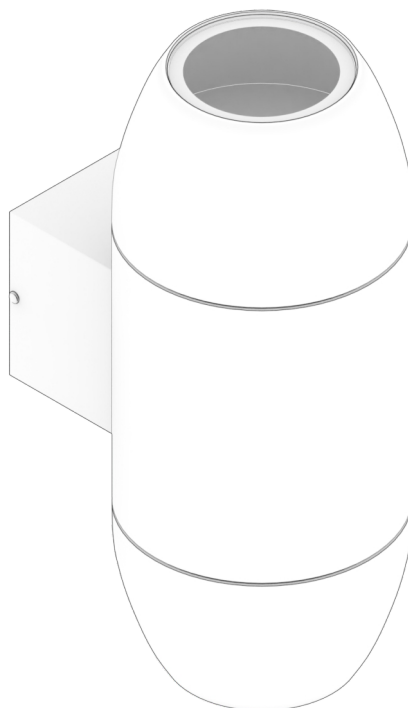
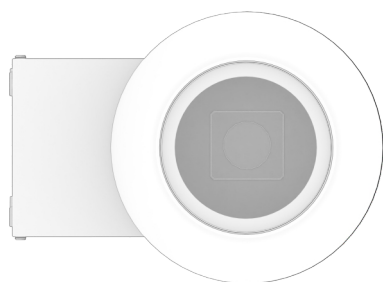
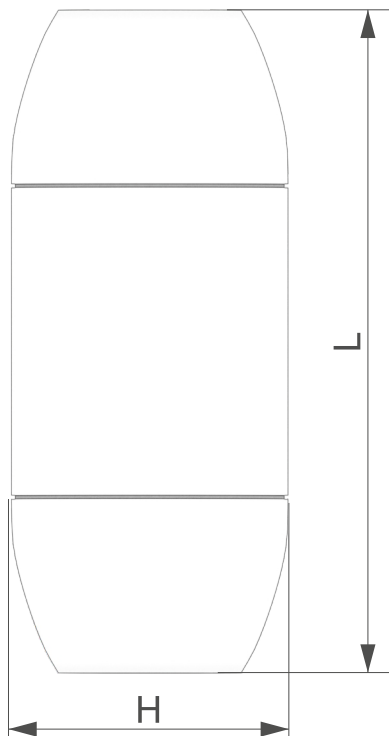
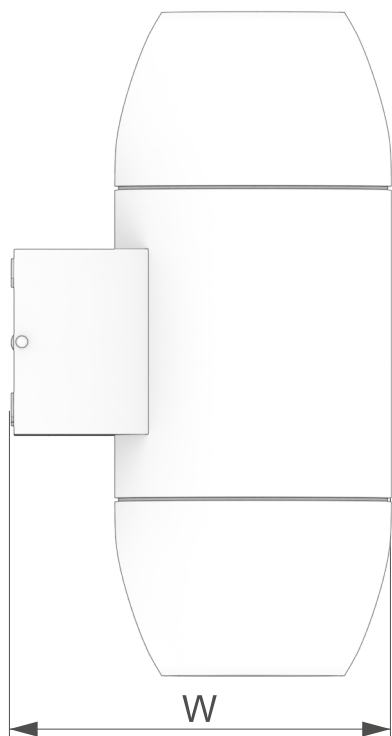

FACADE-11